

BMW K1200GT, K1200S, K1200R LED Flashing Brake Light Kit

Part Numbers: **Dual Function Kit:** WDFK12GTSR (8 LED modules), WDFK12GTSRII (16 LED modules)
Flashing Brake Only Kit: WHLK12GTSR (8 LED modules), WHLK12GTSRII (16 LED modules)

Contents: 1 pair LED modules; Flasher Controller, 2 Posi-Twist connectors; 3 Posi-Tap connector.

Tools Needed: Torx #25 screwdriver .

CAN Bus owners are encouraged to install a Fuse Block with ignition switched relay to simplify installation and operation of all electrical accessories. Hyper-Lites and other accessories can be installed on the fuse block with no interference to the CAN Bus system.

The flasher unit is set to flash continuously while the brake is applied.

To convert to 5 second flash then solid while the brakes are applied, cut the green wire loop on the flasher. Use electrical tape to protect and secure the green wires to the other wires.

1. If using the License Plate Bracket install it now (instructions on bracket package).
2. Remove the rear seat. Empty the storage compartment. Remove the two Torx Head #25 screws (see figure 0) that hold the taillight lens. Remove the Brake Light Bulb Assembly and let it hang gently by the wires. (Figure 1)
3. Mount the LED modules (clean area with alcohol) so that the LEDs point straight back. Press in place for about 5 seconds. The tape can be used only once! If you goof, new tape is required.
4. Locate the motorcycle **BROWN ground** wire from the ground terminal on the brake light Use one of the kit Posi-Tap connectors to tap into the **BROWN ground** wire. Strip the Hyper-Lite **BLACK** wire ½ inch. . Insert the stripped **BLACK** wire into the free end of the Posi-Tap and tighten per the Posi-Tap instructions.

5. Choose a spot on the wiring side of the taillight assembly to mount the flasher module.

Clean with alcohol.

After the alcohol has dried remove the blue covering from the tape and Press the flasher onto the mounting surface for 5 seconds.

6. Locate the motorcycle's **GRAY** wire from either light socket. Install the Hyper-Lite kit **RED** wire on the motorcycle **GRAY** wire using one of the kit Posi-Tap connectors..
7. If you have a Fuse Block with ignition switched relay installed, route the Hyper-Lite **GRAY** wire to a fused circuit on the (relay activated) fuse block.
8. **If you do not have a Fuse Block installed, find the alarm circuit connector under the seat.** Route the Hyper-Lite **GRAY** wire from the flasher module to the **GREEN with White stripe** wire attached to the alarm circuit (see Figure 2). The alarm circuit has five wires. A White with Brown Stripe wire, a White with Black stripe wire, a Red wire, A Brown wire, and the Green with White stripe wire. Pull the wire loom back from the wire. Tap into the GREEN with White stripe wire with the Posi-Tap provided.

9. Route the blue and brown wires from the LED modules to the flasher.

Trim the Blue and Brown wires to remove any excess wire.

Strip each wire 1/2".

Use a Posi-Twist to connect the 3 **BLUE** wires together (see Posi-Twist instructions).

Use a Posi-Twist to connect the 3 **BROWN** wires together.

10. Replace the taillight assembly. Be careful **NOT** to pinch the wires when replacing the taillight assembly. Test all lights!
If installing the **Flashing Brake Only** kit, the Hyper-Lite modules will flash when the brake is applied.

If installing the **Dual Function** kit, the Hyper-Lite modules will be on as running lights then become brighter and flash when the brake is applied. Test all of the other lights. Please call if you have any

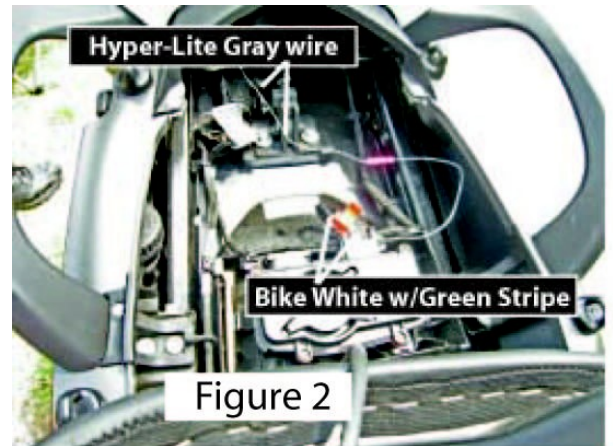
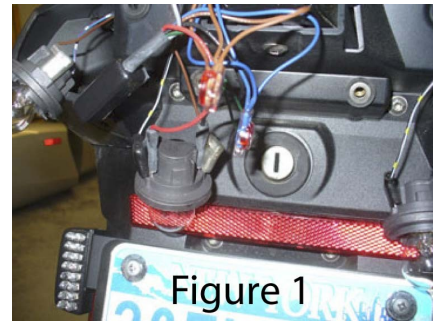
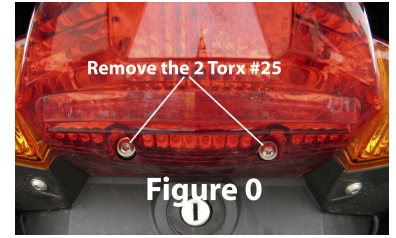

K1200GT power wire installed on alarm circuit using old style red tap in. You will use Posi-Tap. Gray wire left visible for illustration. You will tuck it away neatly.



Posi-Twist™
NON IN-LINE CONNECTIONS

QUICK & EASY!

- 1 Strip wire 1/2"
- 2 Twist
- 3 Insert

- TAPS WIRES WITHOUT CUTTING
- TOTAL WIRE INTEGRITY IS MAINTAINED
- INSTALLS IN SECONDS BY HAND
- NO CRIMPING OR TOOLS REQUIRED
- REUSABLE OR PERMANENT
- LESS RESISTANCE
- VIBRATION PROOF
- FULLY INSULATED

POWERS UP TO (4) LEADS AT ONCE!

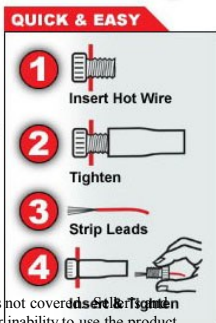

questions. 888.770.1010.

Thanks for choosing Hyper-Lites. Ride SAFE!!